

CartGuard® 2 Flex



Eye-catching color with superior protection.

Our impact-resistant bumper provides reliable protection and a simply beautiful, curved aesthetic. It's designed to fit rounded fixture corners or other curved applications for strong, seamless protection.

Strong Flexible PVC flattens out upon impact and releases impact energy away from store fixtures

Speedy Install All parts snap together for easy installation and guaranteed alignment

Innovative Designed to wrap around curved fixtures and can complete a radius as small as 4 inches

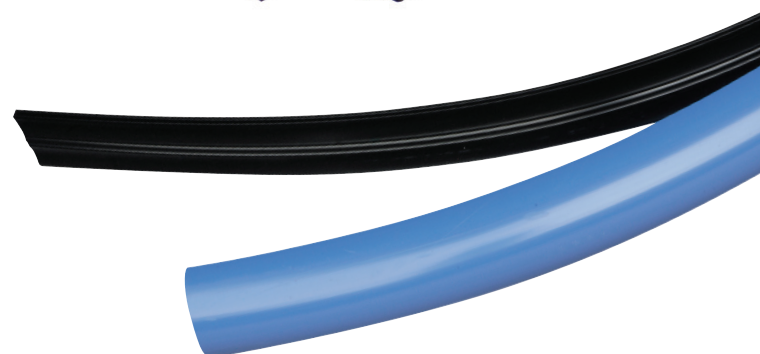

CartGuard® 2 Flex

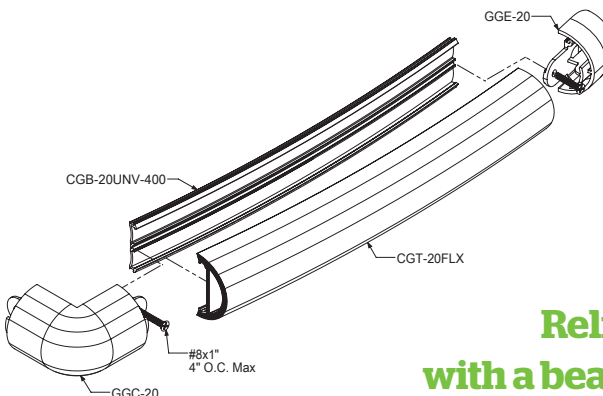
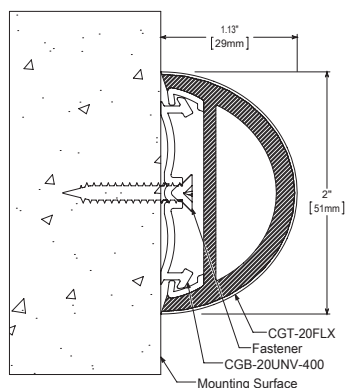

**Reliable protection
with a beautiful aesthetic!**

Components:

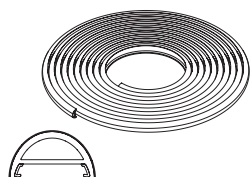

Flexible CartGuard® 2" Top

CGT-20FLX-COLOR

Sold in 72' lengths

Packed: 72' coil per box



2" Mounting Base (PVC)

CGB-20UNV-400

Sold in 12' lengths

Packed: 24 per box (288' total)

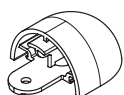

2" Snap-on End Cap

GGE-20-COLOR

Packed: 200 per box

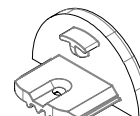

2" Quick Stop End Cap

GGE-20DS-COLOR

Packed: 250 per box

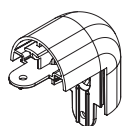

2" Snap-on 90° Corner

GGC-20-COLOR

Packed: 100 per box

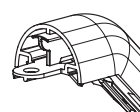

2" Snap-on 135° Corner

GGC-20.45-COLOR

Packed: 100 per box

* 2" Snap-on Custom Corners Available. Metal-reinforced corners made to order for fixture angles between 95°–175°.

401
Black

Stock Colors

Available to  **QuickShip**
within 24 Hours. Please
inquire about quantities
greater than 2,880 feet.

111
Silver

105
Steel
Gray

604
Light
Caramel

101
Gray

501
Red

601
Beige

Standard Colors

Available to ship
within 1 week.



Custom Color Matching

Pre-matched colors ship within 3
weeks. Otherwise allow 6-8 weeks
for delivery. Minimums may apply.



McCue Corporation

Danvers, MA 01923, USA
+1 (800) 800 8503
customer@mcue.com

McCue UK & Europe

Milton Keynes, United Kingdom
+44 (0)1908 365 511
uksales@mcue.com

McCue Asia

迈客(厦门)有限公司
Xiamen, Fujian, China
+86-592-2200790

mcue.com



April 2024